

# CORNER RECORD

Agency Index

Bk 124 Pg 20

Document Number

CR13138

City of EDEN TOWNSHIP

County of ALAMEDA, California

Brief Legal Description BRASS DISK MONUMENT LOCATED WITHIN BARTLETT AVE  
IN FRONT OF 472 BARTLETT AVE

## CORNER TYPE

## COORDINATES (Optional)

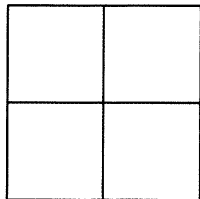

Government Corner	<input type="checkbox"/>	Control	<input checked="" type="checkbox"/>
Meander	<input type="checkbox"/>	Property	<input type="checkbox"/>
Rancho	<input type="checkbox"/>	Other	<input type="checkbox"/>

N. \_\_\_\_\_ E. \_\_\_\_\_

Elevation \_\_\_\_\_

Units Metric ☐ U.S. Survey Foot ☐

Horizontal Datum \_\_\_\_\_

Zone \_\_\_\_\_ Epoch Date \_\_\_\_\_

Vertical Datum \_\_\_\_\_

☐ Complies with Public Resources Code §§8801-8819☐ Complies with Public Resources Code §§8890-8902PLS Act Ref: ☐ 8765(d) ☒ 8771 ☐ 8773 ☐ Other: \_\_\_\_\_

Corner/ Monument:	<input checked="" type="checkbox"/> Left as found	<input type="checkbox"/> Established	<input type="checkbox"/> Rebuilt	<input checked="" type="checkbox"/> Pre-Construction
	<input type="checkbox"/> Found and tagged	<input type="checkbox"/> Reestablished	<input checked="" type="checkbox"/> Referenced	<input type="checkbox"/> Post-Construction

Narrative of corner identified and monument as found, set, reset, replaced, or removed:

☐ See sheet #2 for description(s) :

FOUND 2-1/2" BRASS DISK WITH PUNCH IN MONUMENT WELL

FOUND AND SET POINTS AS SHOWN ON PAGE 2.

THIS POINT WAS REFERENCED PRIOR TO A CONSTRUCTION PROJECT IN THE VICINITY.

THE TIES SHOWN HEREON ARE FOR THE PURPOSE OF PERPETUATING FOUND MONUMENTATION.

NO CLAIM IS MADE AS TO THE RELATIONSHIP OF THE POINTS OR LINES SHOWN HEREON TO TRUE BOUNDARY LOCATION.

## SURVEYOR'S STATEMENT

This Corner Record was prepared by me or under my direction in conformance with

the Professional Land Surveyors' Act on JULY 23, 2019.

Signed Scott V. Cunha P.L.S. or R.C.E. No. LS 8525

SCOTT V. CUNHA

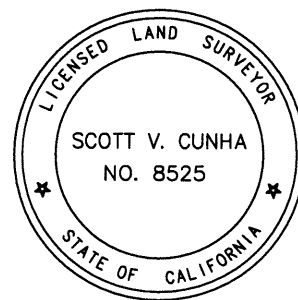

## COUNTY SURVEYOR'S STATEMENT

This Corner Record was received August 9, 2019

and examined and filed September 20, 2019

Signed Dean A. Jurado P.L.S. or R.C.E. No. 9032

Title Interim County Surveyor

County Surveyor's Comment

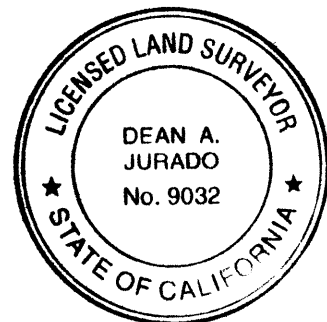

SPEC-2377-Pre

SCALE: 1"=30'

## LEGEND

- FOUND 2-1/2" BRASS DISK WITH PUNCH IN MONUMENT WELL
- ⊗ SET CUT CROSS IN WALK
- ✕ SET CUT CROSS IN CURB

(19592) REFERENCE STREET ADDRESS

