

OWNER'S CERTIFICATE

We hereby certify that we are the owners of, or have some right, title or interest in and to the real property located within the subdivision shown on the herein map, that we are the only persons whose consent is necessary to place a clear title to said real property in, and we hereby consent to the preparation of a map of said subdivision as shown within the distinctive border line.

We hereby dedicate to public use and offer to dedicate to the County of Santa Clara all streets and portions of streets not heretofore existing and designated as "Public Streets" and all easements and rights of way and all public use under, upon and over said streets and portions thereof.

We hereby dedicate to the owners of lots or parcels 2 and 3, their licensees, visitors, tenants and servants an easement, only for pedestrian and bicycle use, a storm drainage easement in, under, over, upon and across that certain strip of land designated as "P.S.E." (Public Service Easement).

We hereby dedicate to public use and offer to dedicate to the County of Santa Clara, a storm drainage easement in, under, over, upon and across that certain strip of land designated as "P.S.E." (Public Service Easement).

All of the herein described streets and easements shall be kept free of buildings except lawful unimproved roof overhangs, and obstructions that impair the use of or are inconsistent with the purposes of the street or easement.

The herein described offers of dedication to the County of Santa Clara are to be accepted only when the Board of Supervisors or its successor agency adopts and records in the Office of the Recorder of Santa Clara County a resolution accepting the same. The herein described offers of dedication are subject to the condition that the developer during any required warranty period and thereafter by the owners of the lots or parcels in the subdivision, the County of Santa Clara shall not be responsible for maintenance and shall incur no liability with respect to such offered streets and easements and shall not be liable for maintenance by the County or other public agency shall be maintained by the owners of the lots or parcels in the subdivision.

We hereby dedicate to public use and offer to dedicate to the County of Santa Clara all streets and portions of streets not heretofore existing and designated as "Public Streets" and all easements and rights of way and all public use under, upon and over said streets and portions thereof.

# TRACT NO. 6021

## EL PASO DE LOS PASTORES

BEING A PORTION OF LOT 6 OF THE HIGUERA PARTITION, FILED IN BK. "V" OF MISC. PG. 225

COUNTY OF SANTA CLARA, CALIFORNIA  
Consisting of 2 sheets  
January, 1978

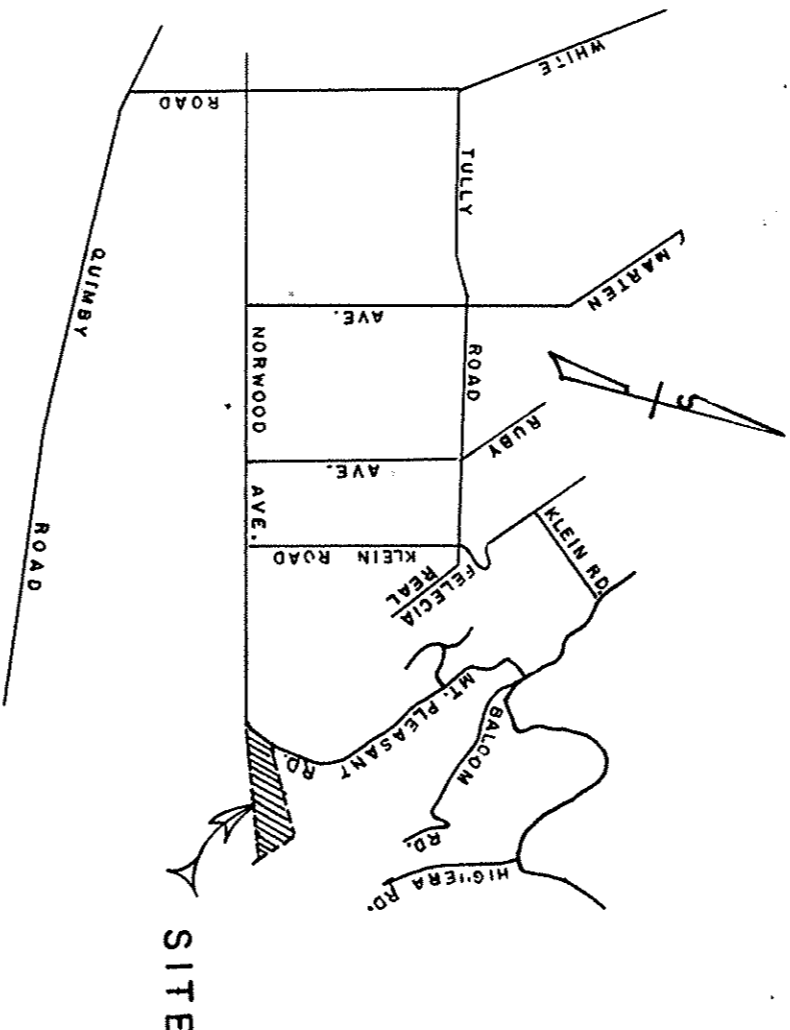

STATE OF CALIFORNIA )  
COUNTY OF STANISLAUS ) SS.

On JUNE 3, 1980 before me, the undersigned a Notary Public in and for said State, personally appeared Richard A. Furrer & Raymond J. Nart known to me to be the Resident of the corporation that executed the within instrument, known to me to be the persons who executed the within instrument on behalf of the corporation therein named, and acknowledged to me that such corporation executed the within instrument pursuant to its by-laws or a resolution of its board of directors.

WITNESS my hand and official seal.

Signed Alexandra Rose  
Name (Typed or Printed)

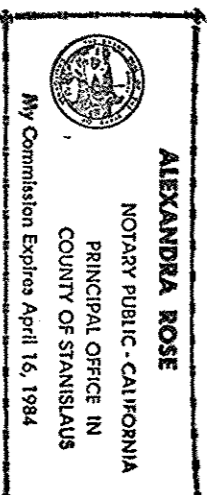

Clerk of the Board of Supervisors Certificate

I hereby certify that the following order was adopted by the Board of Supervisors of the County of Santa Clara, State of California, at a meeting of said Board held on the 14th day of JULY 1980. It is hereby ordered that the Map of Tract No. 6021 be and the same is hereby approved; that all streets, portions of streets and easements offered for dedication to the County of Santa Clara are hereby not accepted; that all dedications to public use are hereby accepted on behalf of the public for the purposes set forth in the owner's certificate.

County Surveyor's Certificate

I hereby certify that I have examined the within final map of Tract No. 6021; that the subdivision shown is substantially the same as it appeared on the tentative map and any approved alterations thereof; that all provisions of the California Subdivision Map Act and any local ordinances applicable at the time of the approval of the tentative map have been complied with and I am satisfied that said map is technically correct.

DEAN P. LARSON, County Surveyor

By: James A. Davis  
Date: July 18, 1980.

County Recorder's Certificate

Filed this 24th day of JULY 1980, at 2:30 P.M. in Book 467 of Maps at pages 42 & 43 at the request of Garcia & Henry Inc.  
File No. 678263 Fee: \$7.00  
GEORGE A. MANN, County Recorder

By: Don L. Johnson

Engineer's Certificate

I hereby certify that this final map and the survey were made by me or under my direction; that the survey made during Sept. 1978 is true and complete as shown; that all the monuments are of the character and occupy the positions indicated, or will be set in such positions on or before 7/1/80, and that such monuments are sufficient to enable the survey to be retraced

By: James A. Garcia, R.C.E. 18576

A Preliminary Soil Investigation Report, prepared by TERRASARCH, dated June 11, 1980 has been received and is on file.

Monumentation Notes

- 1) 1" Iron Pipes tagged R.C.E. 13769 will be set at rear lot corners and curve extremities.
- 2) Front lot lines will be scribbled on the top of the curb.
- 3) Street centerlines will be monumented with Standard County Monuments.



On JUNE 3, 1980 before me, the undersigned a Notary Public in and for said State, personally appeared Richard A. Furrer & Raymond J. Nart known to me to be the Resident of the corporation that executed the within instrument, known to me to be the persons who executed the within instrument on behalf of the corporation therein named, and acknowledged to me that such corporation executed the within instrument pursuant to its by-laws or a resolution of its board of directors.

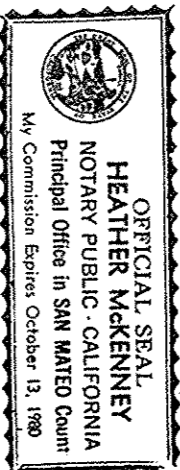

STATE OF CALIFORNIA )  
COUNTY OF SANTA CLARA ) SS.

On JUNE 3, 1980 before me, the undersigned a Notary Public in and for said State, personally appeared Alfred Lead known to me to be the Vice President of the corporation that executed the within instrument, known to me to be the persons who executed the within instrument on behalf of the corporation therein named, and acknowledged to me that such corporation executed the within instrument pursuant to its by-laws or a resolution of its board of directors.

WITNESS my hand and official seal.

Signed Alfred Lead  
Name (Typed or Printed)

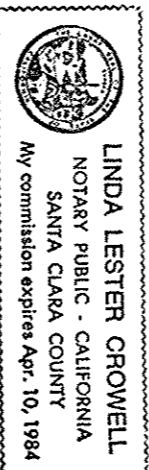

# GARCIA & HENRY

## CIVIL ENGINEERS

17550 MONTEREY STREET

MORGAN HILL, CALIFORNIA 95037

