

CORNER RECORD

Document Number CR 7662

City of HAYWARD County of ALAMEDA, California

Brief Legal Description GENERAL NORTHEASTERLY LINE OF LOT 181, TRACT 3283, PER BK 67 MAPS 82

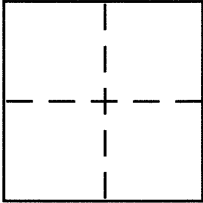

CORNER TYPE

Government Corner ☐ Control ☐
Meander ☐ Property ☒
Rancho ☐ Other ☐
Date of Survey OCTOBER 20, 2015

COORDINATES (Optional)

N. _____
E. _____
Zone _____ NAD27 ☐ NAD83 ☐
NAD83 Epoch _____
Elev. _____
Vert. Datum: NGVD29 ☐ NAVD88 ☐
Meas. Units: Metric ☐ Imperial ☐

Corner – Left as found ☐ Found and tagged ☐ Established ☒ Reestablished ☐ Rebuilt ☐

Identification and type of corner found: Evidence used to identify or procedure used to establish or reestablish the corner:
FOUND: STANDARD CITY OF HAYWARD BRASS DISC MONUMENTS WITH PUNCH IN MONUMENT WELLS,
IN SANDPIPER COURT, AS SHOWN ON TRACT 3283 (67 MAPS 82)

SEE SKETCH ON PAGE 2 OF 2

A description of the physical condition of the monument as found and as set or reset: _____

SET: NAIL & 3/4" BRASS TAG "PLS 7393", AND 1/2" DIAMETER REBAR WITH PLASTIC CAP "PLS 7393"

SEE SKETCH ON PAGE 2 OF 2

SURVEYOR'S STATEMENT

This Corner Record was prepared by me or under my direction in conformance with
the Land Surveyor's Act on OCTOBER 28, 2015

Signed Keith Nofield P.L.S. or R.C.E. No. PLS 7393

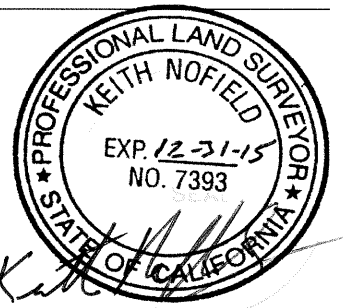

COUNTY SURVEYOR'S STATEMENT

This Corner Record was received 11-12-15
and examined and filed 11-13-15

Signed Russell R. Penland P.L.S. or R.C.E. No. 5726

Title COUNTY SURVEYOR

County Surveyor's Comment _____



