

FINISH SCHEDULE

NO.	MANUFACTURER	DESCRIPTION	SPECIFICATION	JOINT	REMARKS	GROUT	CONTACT
QT	DALTILE	8"X8" QUARRY TILE	COLOR: ASHEN GRAY FINISH: PLAIN	3 / 16"	KITCHEN, SERVICE FLOOR	MFR: MAPEI - 800.42.MAPEI- WWW.MAPEI.COM STYLE: LATEX MODIFIED GROUT #47 COLOR/FINISH: CHARCOAL/SANDED	800.207.2967 EXT. 7263
QT-1	DALTILE	8"X8" QUARRY TILE	COLOR: ASHEN GRAY FINISH: ABRASIVE	3 / 16"	KITCHEN, SERVICE FLOOR	MFR: MAPEI - 800.42.MAPEI- WWW.MAPEI.COM STYLE: LATEX MODIFIED GROUT #47 COLOR/FINISH: CHARCOAL/SANDED	800.207.2967 EXT. 7263
QT-2	DALTILE	COVE BASE TILE	COLOR: ASHEN GRAY FINISH: PLAIN	3 / 16"	KITCHEN, SERVICE BASE	MFR: MAPEI - 800.42.MAPEI- WWW.MAPEI.COM STYLE: LATEX MODIFIED GROUT #47 COLOR/FINISH: CHARCOAL/SANDED	800.207.2967 EXT. 7263
TR100	SCHLUTER	BRUSHED NICKEL ANODIZED ALUMINUM	DILEX-AHK 1S 125 ATGB				
		OUTSIDE CORNER CONNECTION PIECE	DILEX-AHK-E90 / AHK 1S 125 ATGB				
		INSIDE CORNER CONNECTION PIECE	DILEX-AHK-190 / AHK 1S 125 ATGB				
		END CAP PIECE	DILEX-AHK-E / AHK 1S 125 ATGB				
		COVE PIECE	DILEX-AHK-A				
TR101	SCHLUTER	BRUSHED NICKEL ANODIZED ALUMINUM	RONDEC-RO125 AGR				
		OUTSIDE CORNER CONNECTION PIECE	RONDEC-EV / RO125 AGR				
		INSIDE CORNER CONNECTION PIECE	RONDEC-12L / RO125 AGR				
TR102	SCHLUTER	SATIN ANODIZED ALUMINUM	SCHIENE-AE125				

* SCHLUTER SYSTEM ALUMINUM TRIM:

COVE TILE TRIM: SERVICE COUNTER

SCHLUTER SYSTEMS DILEX-AHK 1S 125 ATGB (BRUSHED NICKEL ANODIZED ALUMINUM)

TR100 -OUTSIDE CORNER CONNECTOR PIECE: DILEX-AHK-E90/AHK 1S 125 ATGB (BRUSHED NICKEL ANODIZED ALUMINUM)

-INSIDE CORNER CONNECTOR PIECE: DILEX-AHK-190/AHK 1S 125 ATGB (BRUSHED NICKEL ANODIZED ALUMINUM)

-END CAP PIECE: DILEX-AHK-E/AHK 1S 125 ATGB (BRUSHED NICKEL ANODIZED ALUMINUM)

EDGE TILE TRIM:

SCHLUTER SYSTEMS RONDEC-RO125 ATGB (BRUSHED NICKEL ANODIZED ALUMINUM)

TR101 -OUTSIDE CORNER CONNECTOR PIECE: RONDEC-EV/RO125 ATGB (BRUSHED NICKEL ANODIZED ALUMINUM)

-INSIDE CORNER CONNECTOR PIECE: RONDEC-12L/RO125 ATGB (BRUSHED NICKEL ANODIZED ALUMINUM)

* EPOXY GROUT BY MAPEI, KERAPOXY IEG, 100% SOLIDS INDUSTRIAL GRADE:

AREAS: UNDER HOOD AND 36" IN FRONT OF COOKING LINE, 3 COMPARTMENT SINK AND MOP SINK AREA

SEE MANUFACTURER'S SPECIFICATION, DETAILS AND GUIDE FOR PREPARATION, MIXING, GROUTING AND CLEANING INSTRUCTION

NOTE: SEE INTERIOR SHEETS FOR WALL/ BASE TILE LOCATIONS AND SPECIFICATIONS

FLOOR FINISH LEGEND:

-----< TR100

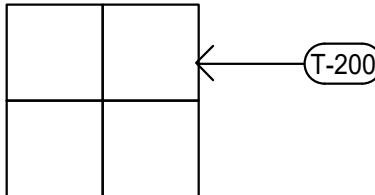

QT

QT-1

AREA OF EPOXY GROUT

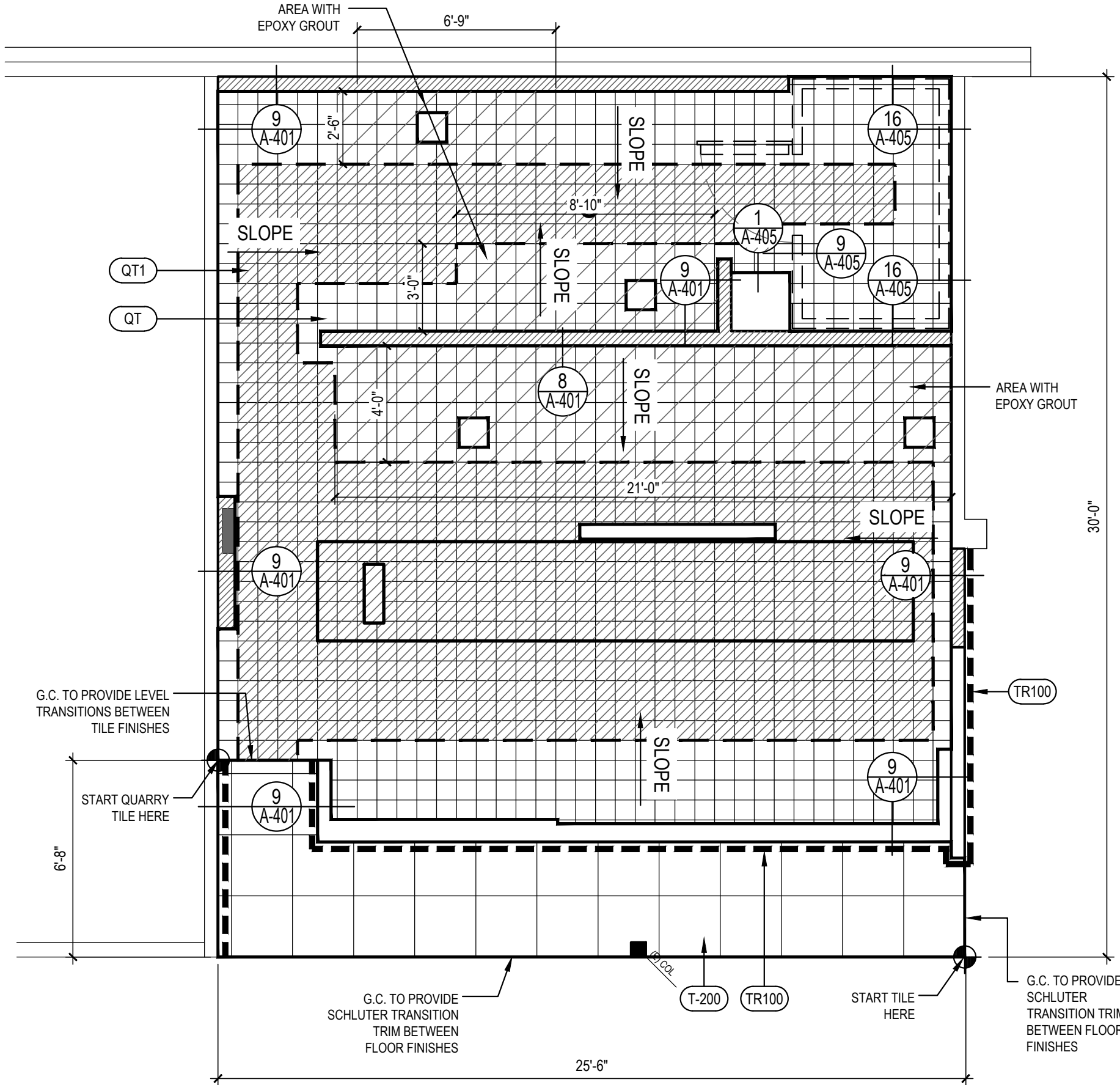

PANDA RESTAURANT GROUP INC.

1683 Walnut Grove Ave.
Rosemead, California
91770

Telephone: 626.799.9898
Facsimile: 626.372.8288

All ideas, designs, arrangement and plans indicated or represented by this drawing are the property of Panda Express Inc. and were created for use on this specific project. None of these ideas, designs, arrangements or plans may be used by or disclosed to any person, firm, or corporation without the written permission of Panda Express Inc.

REVISIONS:

1	PLAN REVIEW COMMENTS	03/26/2021
2	PLAN REVIEW COMMENTS	04/22/2021

ISSUE DATE:

1	95% SUBMITTAL	01/11/2021
2	100% SUBMITTAL	04/16/2021
3	100% RESUBMITTAL	05/14/2021
4	FINAL SUBMITTAL	06/08/2021

DRAWN BY: STAFF

PANDA PROJECT #: D7395

ARCH PROJECT #:



GARY WANG
& ASSOCIATES, INC.

1000 Corporate Center Dr., Ste. 550
Monterey Park, CA 91754
TEL: (626) 288-6898 FAX: (626) 768-7101
http://www.garywang.com



PANDA EXPRESS

ROBINS AFB SHOPPING CENTER
ROBINS AFB, GA

A-104

FINISH PLAN AND SCHEDULE

FINISH SCHEDULE

4

NTS A-104

FLOOR FINISH PLAN

1

Scale: 1/4" = 1'-0"

A-104

BID SET - 2021/06/28